

PROPOSED FIRE CONTROL CENTRE & REGIONAL OFFICE RURAL FIRE SERVICE - SOUTH WEST SLOPES

Drawing Schedule

A.01	OVERALL SITE & LOCALITY PLANS
A.02	PART SITE PLAN
A.03	SITE ELEVATIONS
A.04	SITE ELEVATIONS & TYPICAL SECTION
A.05	STORES SHED

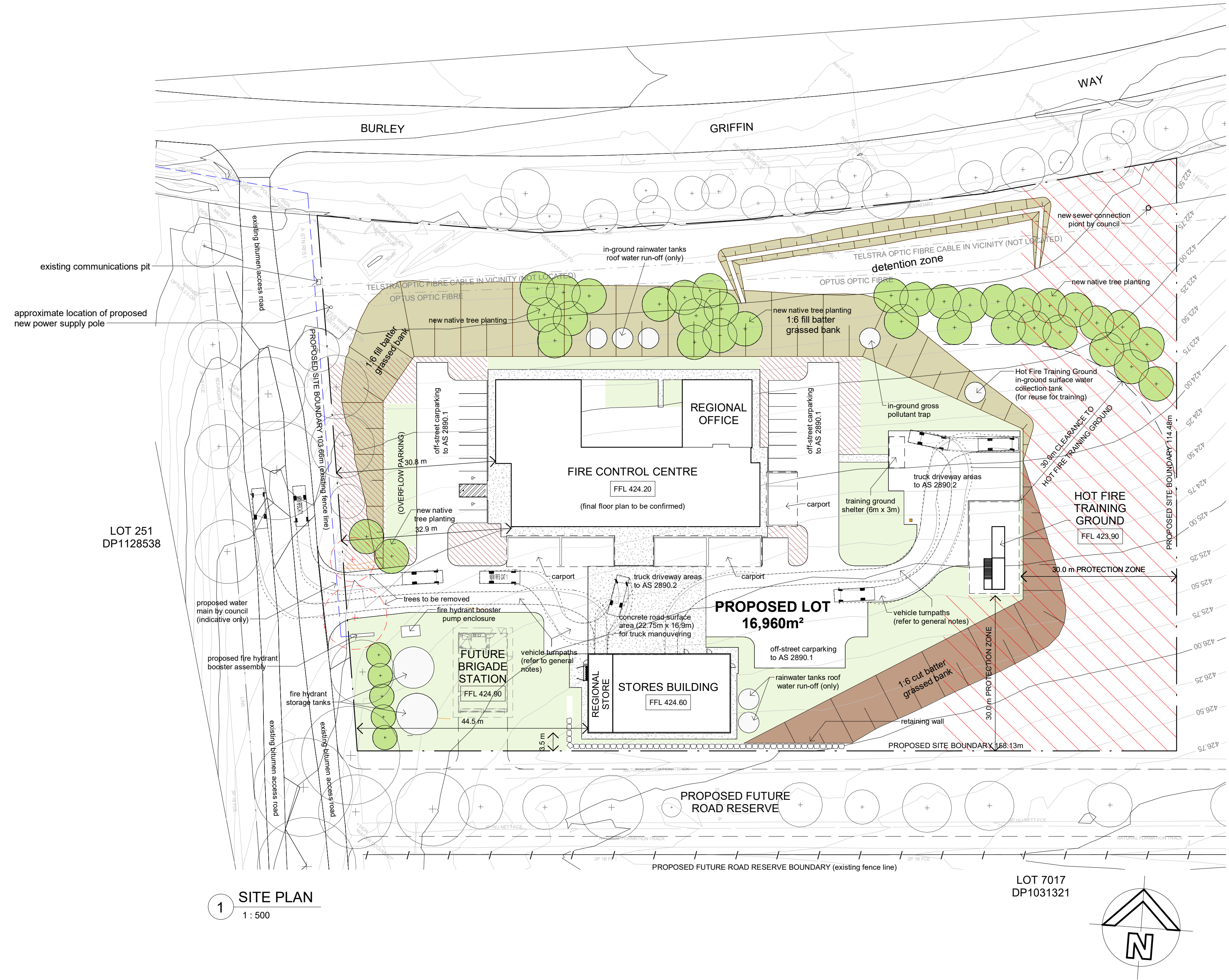

2 LOCALITY PLAN
1: 7500

GENERAL NOTES:

- TURNPATHS SHOWN ARE NSW RURAL FIRE SERVICE CATEGORY 1 VEHICLE (MEDIUM RIGID VEHICLE)
- DISABLED ACCESS TO FIRE CONTROL CENTRE & STORES SHED TO AS 1428.1
- TO BE READ IN CONJUNCTION WITH LANDSCAPE PLAN LD-01

NO.	DATE	REVISION
1	25.10.17	INITIAL LAYOUT FOR COMMENT
2	2.11.17	REVISED LAYOUT FOR COMMENT
3	3.11.17	REVISED LAYOUT FOR COMMENT
4	16.11.17	ISSUED FOR COMMENT
5	23.11.17	DA ISSUE
6	20.02.18	REVISED DA ISSUE
7	29.03.18	REVISED SITE LAYOUT FOR COMMENT
8	04.04.18	REVISED DA ISSUE

FIGURED DIMENSIONS TO BE TAKEN IN REFERENCE TO SCALING.
CHECK ALL DIMENSIONS ON SITE BEFORE FABRICATING ANY ITEM.
THESE DRAWINGS SUBJECT TO COPYRIGHT.

STRUCTURAL/CIVIL CONSULTANT: 170 ranks Street Bathurst NSW 2795 ELECTRICAL SERVICES CONSULTANT: 88 Maitland Road, Mayfield NSW 2404 HYDRAULIC & FIRE SERVICES CONSULTANT: 5/55 Smith Street, Charlestown NSW 2290 LANDSCAPE CONSULTANT: PO Box 1053, Wagga Wagga NSW 2650	Calare Civil tel (02) 6332 3343 Electrical Projects Aust. tel (02) 4967 5999 McCallum PFCA tel (02) 4946 2633 Mark McCrone tel 0407 907 958
--	--

HavenhandMather ARCHITECTS PLANNERS 127 Kippel Street (PO Box 208), Bathurst 2795 Tel 02-63317155 Fax 02-63322115 Email: mail@havenhandmather.com.au Architects Registration Board: 6799	PublicWorks Advisory NSW GOVERNMENT
--	--

PROJECT: SOUTH WEST SLOPES FIRE CONTROL CENTRE & REGIONAL OFFICE BURLEY GRIFFIN WAY, HARDEN, NSW

DRAWING: OVERALL SITE & LOCALITY PLANS
--

JOB NO. 1717	SHEET NO. A.01
SCALE: As indicated	DATE: 20.10.17
DRAWN: CJG	REVISED: 8
CHECKED: DFM	NUMBER IN SET: -